

# Make your trip to SARCAN really count!



## Donate the value of your order to a fundraiser or charity!

*Drop & Go is a new service that is available at all SARCAN depots Saskatchewan. It allows customers to skip lineups by leaving their order at the depot and getting their refunds transferred electronically. Your order will still be counted by our same great staff!*

## Donate your order to



## St Anne Parish, Regina

Follow these easy steps (**Detailed screen shots are included, below**):

- 1) At home, separate your recycling – put plastics, cartons and aluminum cans into bags, put glass beverage containers into boxes. Don't forget to include milk containers!
- 2) Visit a SARCAN Depot and look for Drop & Go – *for a full list of locations, see the reverse side of this page.*
- 3) Follow instructions on the screen. Type  **blessings**  when prompted to enter the group phrase. It is simple!
- 4) The amount of your order will be processed and paid directly to the **St. Anne Parish, Regina.**

The group phrase works at all 72 depots across the province, so your friends and family across Saskatchewan can donate too!

## DROP & GO LOCATIONS

### How to get to Drop & Go

Regina Rochdale

- Entrance to the right of the main doors

Regina Vic East

- Entrance to the left of the main doors

For all other SARCAN depots, Drop & Go is located inside the customer area. Just watch for pink signs when you arrive or speak to one of our friendly staff members.

Steps to use Drop & Go to donate your recycling to St. Anne's Parish, Regina:

1. Go to the Drop & Go terminal. The screen will look like this:

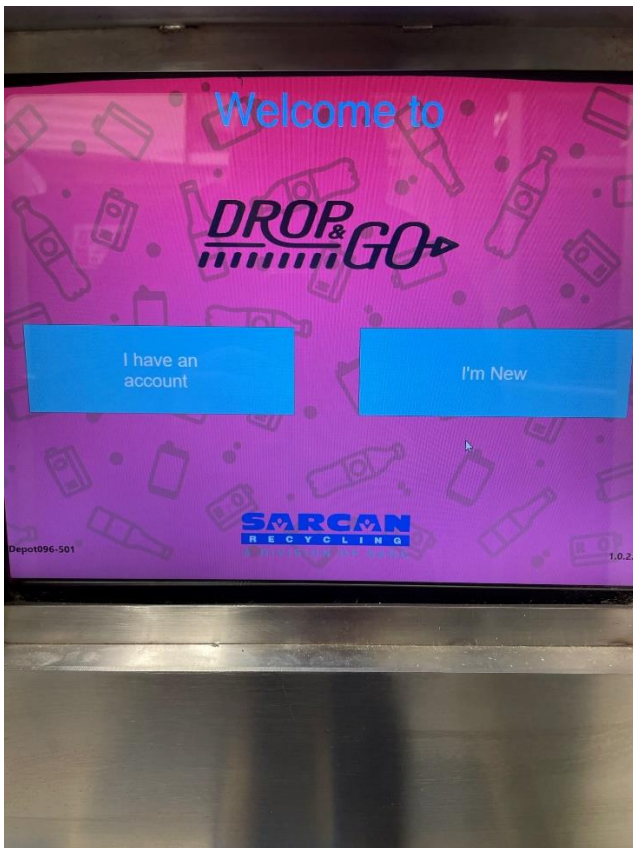

2. Choose "I have an account". The next screen will look like this:

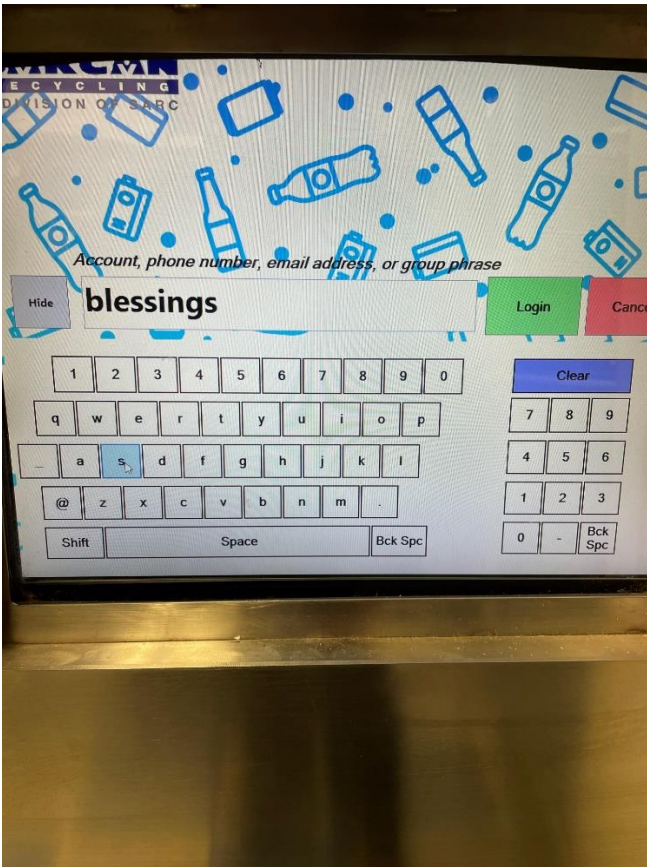

3. Type in the word "blessings" as the group phrase. The next screen will look like this:

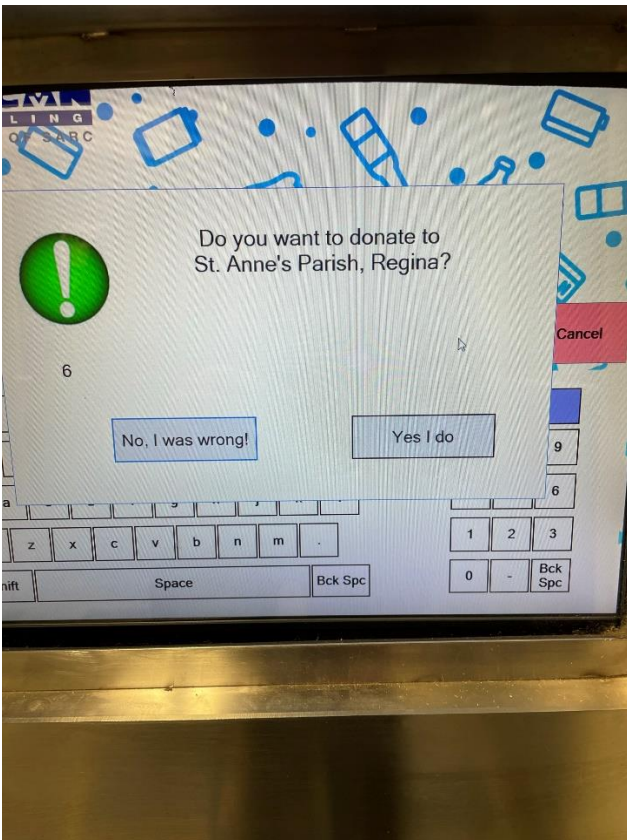

4. Select "Yes I do". The next screen will look like this:

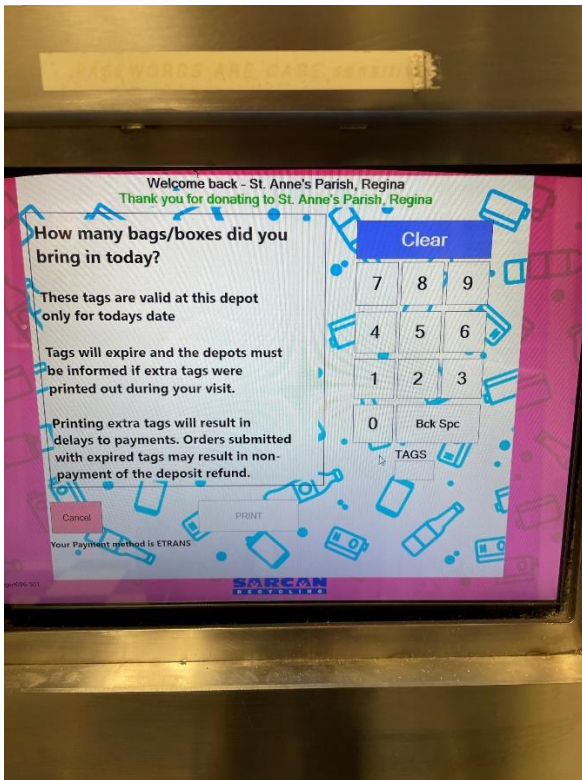

5. In this example, we are donating one bag, but please **enter the number of bags** that you are donating. The next screen looks like this:

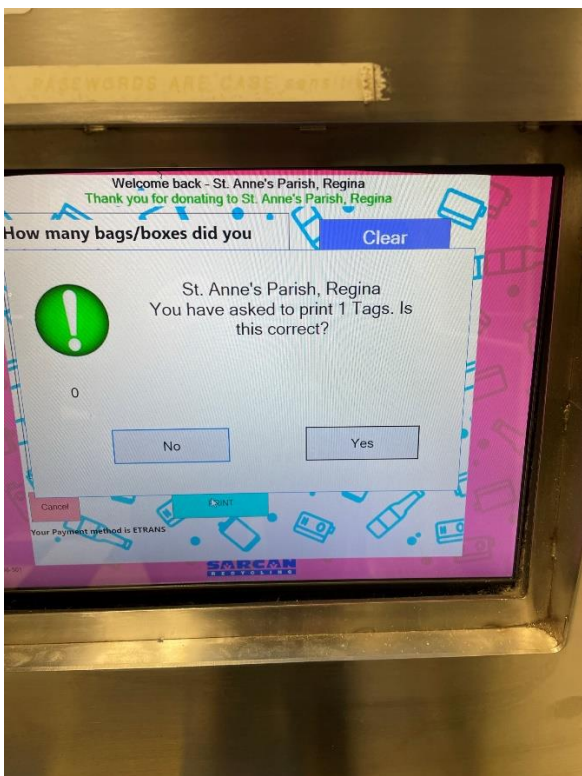

6. If this is the correct number of bags press **“yes”**. Otherwise press **“no”** to re-enter the number of bags. Once you press **“yes”** your stickers will print. Attach one sticker to each of our bags, print your receipt, and then drop your bags off. At the Grant Road SARCAN location, the Drop & Go door is behind the building. At the Victoria Ave East SARCAN location, the Drop & Go turnstile is on the left when you enter the building.

**Thank you for your donation and your continued support  
of St. Anne’s Parish!**

**God Bless!**